

**INSTALLATION INSTRUCTIONS
FOR
LEGEND® LIGHTBAR PERMANENT MOUNTING KIT**

▲WARNING

The lives of people depend on your proper installation and servicing of Federal products. It is important to read and follow all instructions shipped with the products. In addition, listed below are some other important safety instructions and precautions you should follow:

- To properly install a light assembly: you must have a good understanding of automotive electrical procedures and systems, along with proficiency in the installation and use of safety warning equipment.
- When drilling into a vehicle structure, be sure that both sides of the surface are clear of anything that could be damaged.
- Refer to instruction sheet packed with light system for proper electrical connections.
- You should frequently inspect the light system to ensure that it is securely attached to the vehicle.
- Refer to the instruction sheets packed with related products for additional precautions and information.
- File these instructions in a safe place and refer to them when maintaining and/or reinstalling the product.

Failure to follow all safety precautions and instructions may result in property damage, serious injury, or death to you or others.

I. GENERAL.

This instruction sheet provides instructions for installing the Legend light bar mounting kit. Plan all cable routing prior to installing unit.

II. UNPACKING.

After unpacking the kit, carefully check all envelopes, shipping labels, and tags before removing or destroying them. Ensure that the parts shown in the KIT CONTENTS LIST are contained in the packing carton.

III. KIT CONTENTS LIST.

Qty.	Description	Part No.
2	Foot, Mounting, Perm Mount	8653108-01
4	Pad, Foot, 0.29"	8653157-03
4	Pad, Foot, 0.44"	8653157-04
4	Pad, Foot, 0.69"	8653157-07
8	Bolt, Carriage, 5/16-18 x 1"	7004025-16
8	Washer, Flat, 5/16	7072A031
8	Washer, Lock, 5/16 Split	7074A020
8	Nut, 5/16-18	7059125
4	Bolt, Toggle, 1/4-20	8422A032
4	Washer, Flat, 1/4"	7072A024
4	Nut, Jam, 1/4-20	7057A049
4	Nut, Acorn, 1/4-20	7054A010
2	Cover, Hook Access	8653121

IV. FOOT INSTALLATION (see figure 1).

A. Turn the light assembly over so that the bottom faces up. The unit should be placed on soft rags or cardboard to avoid marring the plastic domes. Insert two 5/16-18 Carriage Bolts into each track (four total) via the center access holes and position as shown to match holes in Mounting Foot.

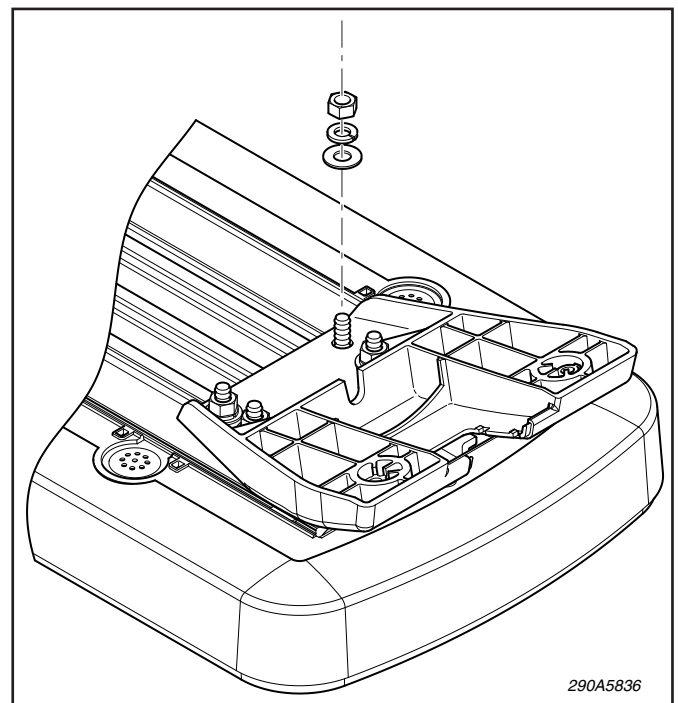

Figure 1.

B. Place a Mounting Foot over the four Carriage Bolts. Install four 5/16 flat washers, lock washers, and nuts, leaving nuts just loose enough to reposition Mounting Foot. Do not tighten at this time.

C. Temporarily attach two 0.29" thick Mounting Pads to the Mounting Foot with tape. Do not cover hole in pad or foot with tape.

D. Repeat A-C for the other side.

V. INSTALLATION ON VEHICLE ROOF.

A. Place the light assembly on the vehicle roof at the desired location. Usually the unit is installed so that the bar is centered on the door center post.

B. Adjust both mounting foot assemblies in or out, as necessary, until the Foot Pads rest near the edge of the roof or gutter where the roof is the most rigid. Both the lightbar and the mounting feet should be centered left-to-right on the vehicle.

C. Check to ensure that the unit is level front-to-back. If it is not level, it can be modified by using different thickness Foot Pads and/or repositioning the light assembly slightly forward or back.

D. Using the mounting feet as a template, scribe two drill position marks on each end of the lightbar.



Do not overtighten screws or nuts.

E. Carefully remove the lightbar, invert it on soft rags, and tighten the eight 5/16 nuts that secure the mounting feet to the bar. Recheck the positioning of the scribed drill marks.



To avoid damage when drilling, ensure that both sides of mounting surface are clear of any parts or wires.

Also, when drilling holes, ensure that holes are drilled only through sheet metal and NOT through upholstery.

F. Drill four 1/2-inch diameter holes at the previously scribed drill position marks.

G. See figures 2 and 3. Insert a toggle bolt in each of the four holes drilled in the previous step. Slide the appropriate rubber mounting pad over each bolt as it is installed. Use caution to avoid dropping the bolts through the holes before the rubber mounting pads are installed.

H. See figure 3. Place the mounting feet down over the ends of the toggle bolts, install two 1/4" flat washers,

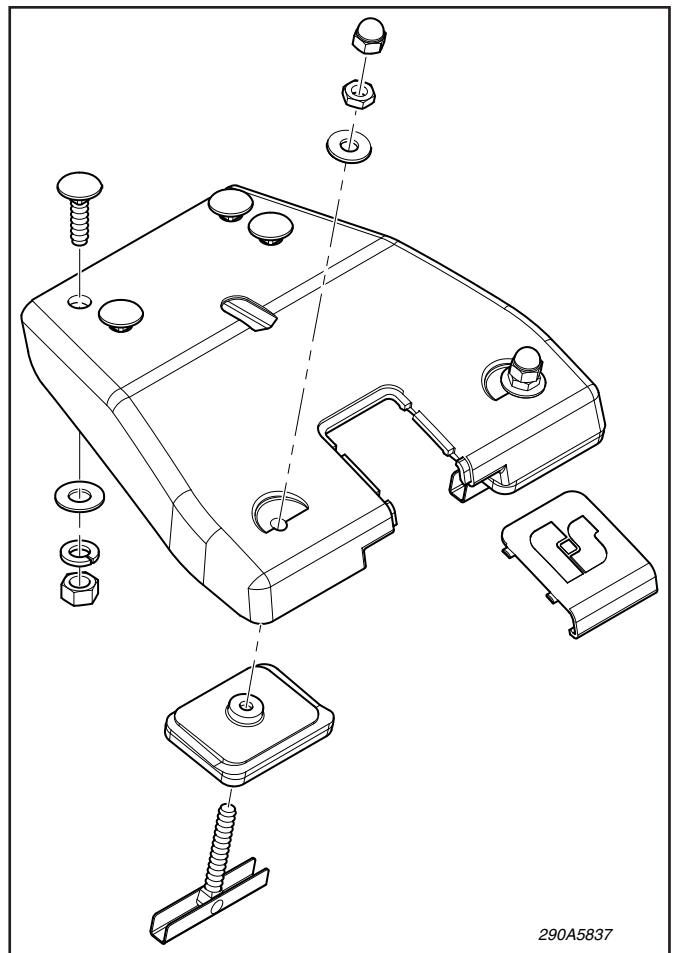

Figure 2.

and secure with the jam nuts. Saw-off the toggle bolts 3/16-inch above the jam nuts and screw-on the cap nuts. The unit should now be solidly anchored to the roof.

I. Slide the Hook Access Covers into position (snap fit) and ensure that all fasteners are properly tightened.

J. Frequently inspect the light assembly to ensure that all fasteners and brackets are tight.

Manufactured by:
 Federal Signal Corporation
 Emergency Products Group
 2645 Federal Signal Drive
 University Park, Illinois 60466
 1-800-433-9132

Copyright 2007 Federal Signal Corporation

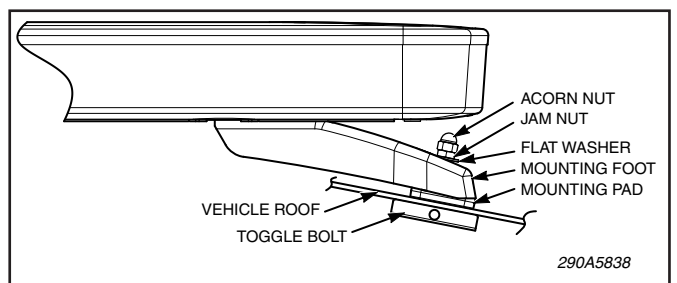

Figure 3.